

TRINITY PRESBYTERIAN CHURCH

HENDERSONVILLE, NORTH CAROLINA 28739

MESSAGE FROM THE PASTOR

In June of 1967 the congregation of Trinity Presbyterian Church adopted the following mission:

- (1) To proclaim the gospel in word and deed.
- (2) To nurture the members of Christ's Church.
- (3) To provide a ministry of compassion in the name of Christ.

The building that is outlined in this brochure is one of the tools needed to carry out this mission. While it involves a major effort in terms of time and money, it must be seen as a means to an end and not as an end in itself. As a congregation we feel that God has called us to mission, and not just to erect a building. It is the conviction of the planning council that this building will be helpful in fulfilling our mission.

As you study this brochure I hope that you will share this conviction and will commit yourself to this adventure into the future with Christ and your fellow churchmen.

Faithfully Yours,

Hugh L. Eichelberger
Pastor



HUGH L. EICHELBERGER
PASTOR

WE ARE SPIRITUALLY STRONG BUT LACKING IN PHYSICAL FACILITIES - - -



Our present building located at 1403 Fifth Ave. West, has served us well the past few years, but we have outgrown the facilities. Parking is completely inadequate. Sunday school classrooms must be set-up in the sanctuary and taken down before the service to provide enough space for all to meet.

Our present "sanctuary" consists of three rooms in an "L" shape, which necessitates our pastor addressing two separated groups. The present seating capacity of these three rooms is 100 with no real "overflow capacity". At one service last year we had 135 worshipers, necessitating seating on benches along the walls and standing in spaces where chairs could not be placed.



CHURCH MASTER PLAN -

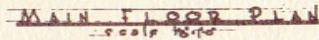

This is the floor plan proposed for our future congregation — The building, to be completed in 3 phases, would meet the needs of 500 members.

OUR FIRST PHASE OF BUILDING

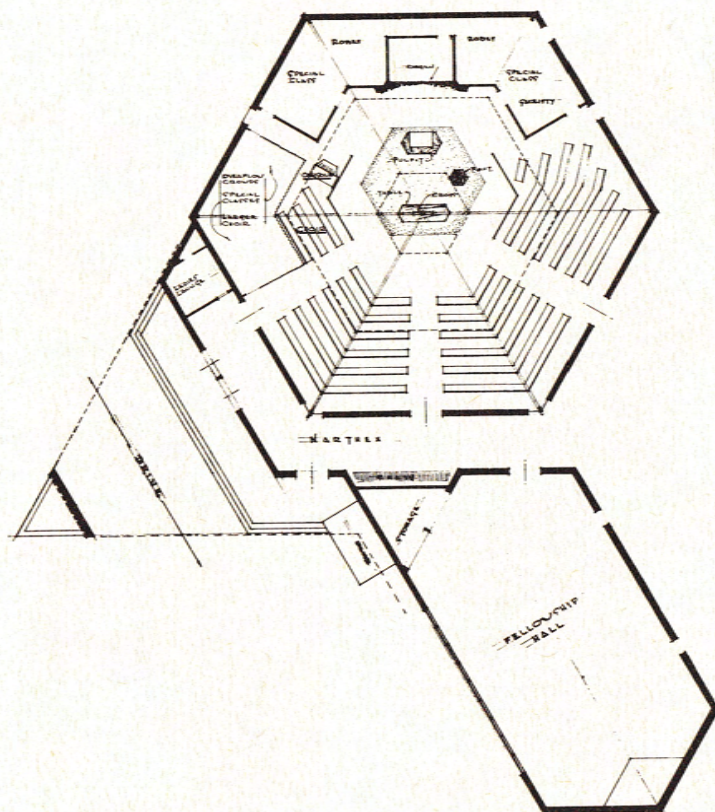

Due to the numbers of our present membership we cannot expect to build a first unit which has all of the things we might desire in a church building. We can, however, have a building which is not only very functional but which also is most attractive.

This floor plan includes a sanctuary for our regular worship that can be expanded as our membership grows. A portion of the sanctuary will be temporarily partitioned off as classrooms, the fellowship hall will be divided into additional classrooms and offices by walls that can be removed. There will also be temporary kitchen facilities, and a fellowship hall where approximately 100 persons can be seated for meals.

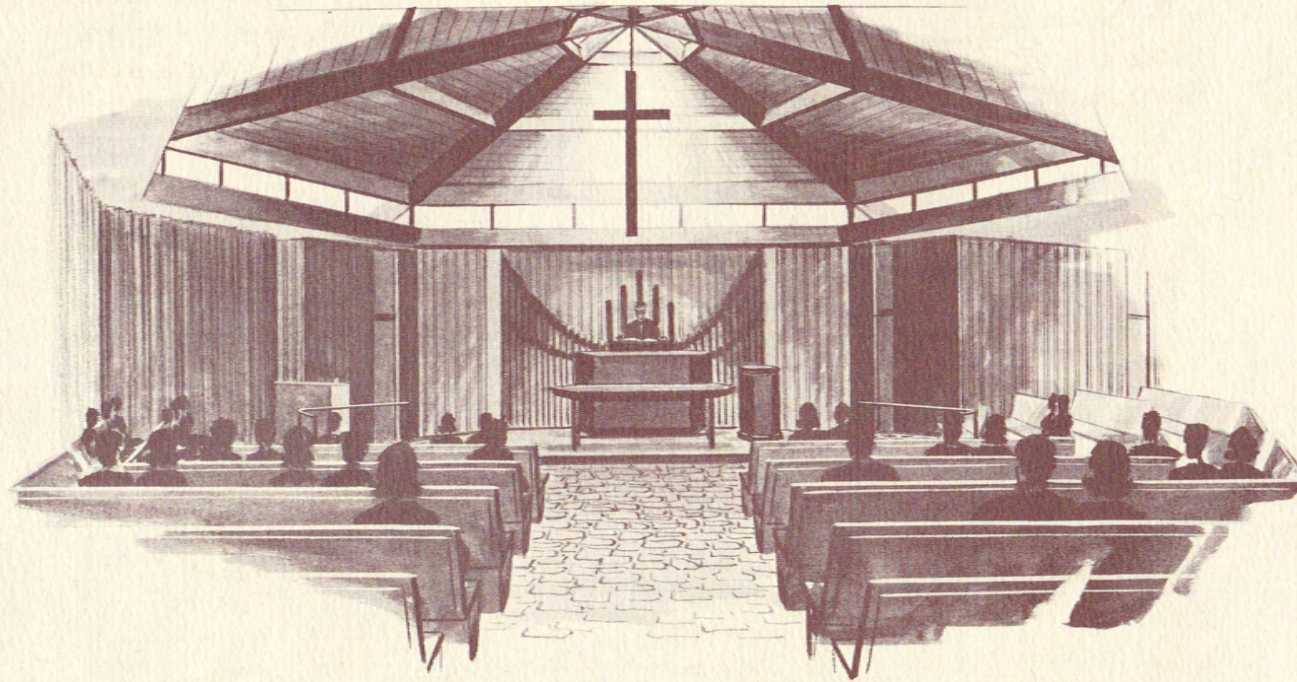

Our sanctuary will be both dramatic and functional. Skylights will allow sunlight to strike the pulpit area and illuminate the sanctuary. The hexagonally shaped sanctuary allows for seating of 350 worshipers with no one being more than forty-five feet from the pulpit. The closeness is designed to give every worshiper a sense of participation in the service.

UNTO GOD THE THINGS THAT ARE GOD'S!

The value of the first unit of our building program will be approximately \$150,000 with the complete master plan in excess of \$300,000. We presently have \$7,000 in the building fund. To build phase I an additional \$65,000 must be pledged by the congregation in this building fund campaign.

HOW MUCH SHOULD YOU GIVE?

Confronted by these needs, only you know what response, in the light of your total responsibilities, will represent a fair and generous expression of your interest and concern. To be successful we need the following investments in our future:

Number of Givers	Individual 3 Year Pledge	Group 3 Year Total	Cumulative 3 Year Total
1	\$5,000-10,000	\$6,000	\$6,000
2	3,500- 5,000	7,000	13,000
3	2,000- 3,500	8,000	21,000
5	1,500- 2,000	8,000	29,000
8	1,000- 1,500	9,000	38,000
13	600- 1,000	10,000	48,000
35	300- 600	17,000	65,000

SCHEDULE FOR PLEDGES 3 YEARS — BEGINNING MAY 1, 1968

QUARTERLY		MONTHLY		WEEKLY	
12 Quarterly Payments	Total	36 Mo. Payments	Total	156 Weekly Payments	Total
\$500	\$6,000	\$150	\$5,400	\$ 25	\$3,900
400	4,800	100	3,600	20	3,120
300	3,600	75	2,700	15	2,340
200	2,400	50	1,800	10	1,560
150	1,800	40	1,440	8	1,248
125	1,500	30	1,080	6	939
100	1,200	25	900	5	780
75	900	20	720	4	624
50	600	15	540	3	468

It is supposed that everyone knows by now that his gifts to the church are deductible in computing income taxes. But many are unaware that such gifts may take another form than money.

Stocks, bonds, mutual fund shares, debentures or other securities grow in value through the years, and the owner is required to pay a tax on the increase at the time of selling. Such taxes can be avoided by the transfer of those securities to this building campaign, while the entire amount of the present value can be deducted on your tax return.

Also, planning for your future giving by means of trusts, or through life insurance might also be investigated with good advantage to you.

PLANNING COUNCIL

Louise Brittain
James Hinson
Philip Sellers
Richard Valore

BUILDING FUND COMMITTEE

Paul Avant	Neena Haskins
Art Gebhardt	Anne Stoneman
William Gilbert	Freeman Schelberg
Leonard Barber	James Yuill
Bill Strickland	Bill Welsh
Clayton O'Neil	

A Plan For Giving

The building fund campaign which confronts us is one of wide dimension. It means each of us must be good and faithful stewards. When all the facts are considered, the building of our church building is not an expense but an investment which will enable our congregation to carry out its mission. The cost lies not in building but in failing to build, so that we can fulfill our mission.

What is my share? In the final analysis, the amount of each person's giving will depend on how that individual feels about Christ and His church. Our building will be built if each of us individually accepts the challenge and determines that this responsibility will be met.